



OT-125

HONDA / ACURA CRANKSHAFT DAMPER HOLDING TOOL

Tool allows the technician to hold the crankshaft damper when tightening or loosening the crankshaft bolt.

Works on the following Honda and Acura engines:

1990–1997 Honda Accord 2.2L 4 cyl.

1996–1997 Honda Accord 2.7L V-6

1998–newer Honda Accord 2.3L 4 cyl. & 3.0L V-6

1992–newer Honda Civic 1.6L 4 cyl.

1997–newer Honda CR-V 2.0L 4 cyl.

1993–1997 Honda Del Sol 1.6L 4 cyl.

2000–newer Honda Insight 1.0L 3 cyl.

1995–1997 Honda Odyssey 2.2L 4 cyl.

1998 Honda Odyssey 2.3L 4 cyl.

1999–newer Honda Odyssey 3.5L V-6

1992–newer Honda Prelude 2.2L 4 cyl.

1992–1996 Honda Prelude 2.3L 4 cyl.

2000–newer Honda S2000 2.0L 4 cyl.

1997 Acura CL 2.2L 4 cyl.

1997–1998 Acura CL 3.0L V-6

1998–1999 Acura CL 2.3L 4 cyl.

2000–newer Acura CL 3.2L V-6

1990–1992 Acura Integra 1.6L 4 cyl.

1992–1993 Acura Integra 1.7L 4 cyl.

1993–newer Acura Integra 1.8L 4 cyl.

1991–1995 Acura Legend 3.2L V-6

1996–newer Acura RL 3.5L V-6

1995–newer Acura TL 3.2L V-6



OT-127

COPPER WASHER REMOVAL TOOL FOR DIESEL INJECTOR

- Size: inner hole 7
- Length: 230mm
- Collet type easy to holding the copper washer.



OT-143

SEAL PULLER

Heavy-duty, heat-treated steel.

Easily removes grease and oil seals.

Red vinyl, non-slip handle.

2 tips for multiple applications.



OT-145

SPARK PLUG HOLE THREAD CHASER

Tapered double ended for both 14m/m and 18m/m threads designed to start and remove carbon & dirt or straighten damaged threads in spark plug hole.

Use with deep socket, open ends or boxes wrench.

M14 x 1.25 & M18 x 1.5 , Subtense : 21mm



OT-145A

SPARK PLUG HOLE THREAD CHASER

Tapered 18m/m threads designed to start and remove carbon & dirt or straighten damaged threads in spark plug hole.

Use with deep socket, open ends or boxes wrench.

M18 x 1.5 , Subtense : 21mm



OT-145B

SPARK PLUG HOLE THREAD CHASER

Tapered 18m/m threads designed to start and remove carbon & dirt or straighten damaged threads in spark plug hole.

Use with deep socket, open ends or boxes wrench.

M14 x 1.25 , Subtense : 22mm



OT-145C

SPARK PLUG HOLE THREAD CHASER

Tapered 18m/m threads designed to start and remove carbon & dirt or straighten damaged threads in spark plug hole.

Use with deep socket, open ends or boxes wrench.

M18 x 1.5 , Subtense : 22mm



OT-145D

SPARK PLUG HOLE THREAD CHASER

Tapered 18m/m threads designed to start and remove carbon & dirt or straighten damaged threads in spark plug hole.

Use with deep socket, open ends or boxes wrench.

M12 x 1.25 , Subtense : 22mm



OT-145E

SPARK PLUG HOLE THREAD CHASER

For cleaning of plug threads size :

M12 x 1.25 & M10 x 1.0 , Subtense : 21mm



**OT-145F
SPARK PLUG HOLE THREAD CHASER**

For cleaning of plug threads size :
M14 x 1.25 & M12 x 1.25 , Subtense : 21mm



**OT-145G
SPARK PLUG HOLE THREAD CHASER**

Tapered 18m/m threads designed to start and remove carbon & dirt or straighten damaged threads in spark plug hole.
Use with deep socket, open ends or boxes wrench.
M12 x 1.25 , Subtense : 21 mm



**OT-145I
33PCS GLOW PLUG THREAD REPAIR SET**

- Designed to repair the thread for the glow plug threads.
- Tap size :
M8 x1.0, M10 x1.0, M10 x1.25, M12 x1.0, M12 x1.25, M14 x1.25
- Thread coil size :
M8 x1.0 (I) - M10 x1.0 (E), M10 x1.0 (I) - M12 x1.0 (E),
M10 x1.25 (I) - M12 x1.25 (E), M12 x1.25(I) - M14 x1.25 (E)
- 2-Thread coil driver



**ST-361
SPARK -PLUG SOCKET 14mm**

- Suitable for Renault Coil 1,2 16V ; Twingo 1,2 16V.
- Size: 3/8"Dr. x 14mm x 12PT x 250 mm long.
- Magnet inner



**ST-362
SPARK -PLUG SOCKET 16mm**

- size: 3/8"Dr. x 16mm x 12PT x 250 mm long.
- Magnet inner



ST-361A

SPARK -PLUG SOCKET 14mm

- Suitable for Renault Coil 1,2 16V ; Twingo 1,2 16V.
- size: 3/8"Dr. x 14mm x 12PT x 250 mm long.
- Rubber inner



ST-362A

SPARK -PLUG SOCKET 16mm

- size: 3/8"Dr. x 16mm x 12PT x 250 mm long.
- Rubber inner



OT-166

GLOW PLUG DRILLING SET

Diesel Engine requires GLOW PLUG for combustion process in engine cylinder. The heating element in glow plug heat up and drive the cylinders gradually. But the heating elements are very delicate, and require special tool for removing the glow plug.



OT-166A

7PCS GLOW PLUG PULLER SET

- Designed to pull out the broken head glow plug on the engine.
- 5pcs outside holder jaw size: $\text{§ } 2.7 \times 1$, $\text{§ } 3.6 \times 1$, $\text{§ } 5 \times 2$, $\text{§ } 6 \times 1$.
- 1pcs inside holder jaw size: $\text{§ } 5.5$.



OT-166B

VW, AUDI INJECTOR SEAT CLEANING SET

- Suitable for 2.0 TDI engine from VAG group.
- To clean the contact surface between the injector and engine head when making the replacement.
- Include cutter holder can made straight and correct to attach when cleaning.
- Insert the extension bar in to the cutter for deep hole cleaning



OT-151

UNIVERSAL STRETCH FIT INSTALLATION TOOL

- Universal stretch fit installation tool is available separately for applications where a tool must be used.
- The universal tool is more economical and environmentally friendly than disposable versions.
- Stretch fit installation kit includes a re-usable universal tool and mounting bolt.

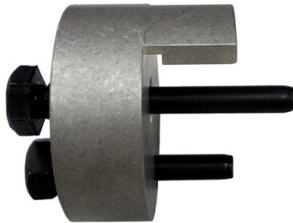

OT-151A

UNIVERSAL STRETCH FIT INSTALLATION TOOL

- Universal stretch fit installation tool is available separately for applications where a tool must be used.
- The universal tool is more economical and environmentally friendly than disposable versions.
- Stretch fit installation kit includes a re-usable universal tool and mounting bolt.

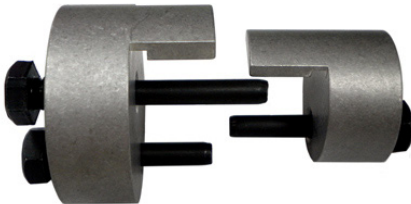

OT-151B

UNIVERSAL STRETCH FIT INSTALLATION TOOL

2pcs/set universal stretch belt tool set

- Universal stretch fit installation tool is available separately for applications where a tool must be used.
- The universal tool is more economical and environmentally friendly than disposable versions.
- Stretch fit installation kit includes a re-usable universal tool and mounting bolt.

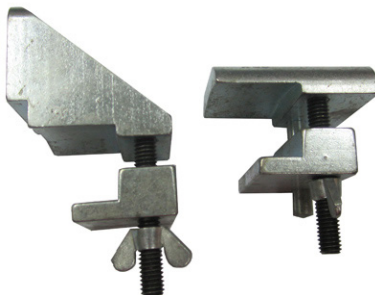

OT-151C

BELT TOOL KIT FOR ELASTIC-RIBBED BELTS

- Suitable for engines with elastic ribbed belts such as Alfa Romeo, BMW, Chrysler, Fiat, Ford, Mercedes, PSA, Seat, Skoda, Smart, Volvo, VW-Audi, etc...
- This tool set is quickly and easily removal and installation of the new elastic ribbed belts required.



OT-151D

3PCS BELT INSTALLING TOOL SET

- Special designed set of tools for installing the new belt onto the pulley.
- Applicable:FORD, MAZDA, VOLVO, BMW, CHRYSLER, CITROEN, FIAT, LANCIA, ETC...



OT-151E 5PCS BELT INSTALLING TOOL SET

- Special designed set of tools for installing the new belt onto the pulley.
- Suitable for engines with elastic ribbed belts such as Alfa Romeo, BMW, Chrysler, Fiat, Ford, Mercedes, PSA, Seat, Skoda, Smart, Volvo, VW-Audi, Mazda, Lancia, Citroen, etc...



OT-152 MAGNETIC CAMBER GAUGE

- Accurate camber measuring tool for use after repairs or replacement of struts, wheel assemblies etc. for cars and trucks.
- Vials housed in a durable non-magnetic casing with a magnetic head that attaches firmly to rotors or spindles.
- Range : 5 positive to 5 negative in 1/2 increments.



OT-152A MAGNETIC CAMBER GAUGE

- Accurate camber measuring tool for use after repairs or replacement of struts, wheel assemblies etc. for cars and trucks.
- Vials housed in a durable non-magnetic casing with a magnetic head that attaches firmly to rotors or spindles.
- Gauge can be preset at any angle 0 to 90 before making adjustment.
- Range : 5 positive to 5 negative in 1/2 increments.



OT-152B MAGNETIC CAMBER GAUGE

- Accurate camber measuring tool for use after repairs or replacement of struts, wheel assemblies etc. for cars and trucks.
- Vials housed in a durable non-magnetic casing with a magnetic head that attaches firmly to rotors or spindles.
- Gauge can be preset at any angle 0 to 90 before making adjustment.
- Range : 5 positive to 5 negative in 1/2 increments.



**OT-156
SELF-GRIPING OIL FILTER WRENCH**

- 1/2" Drive.
- Suitable For Filter 95-165mm



**OT-163
COMPRESSION TEST ADAPTOR**

- This extra long compression test adaptor is designed to fit 12mm spark plugs.
- This tool is now essential on BMW E90 335i with N54 engine 2006 , BMW MINI, MERCEDES M156.
- Alos used on Peugeot 207/307 and Renault 1.2 16 valve engine .



**OT-163A
VALVE COMPRESSOR EXTENSION TUBE**

- Special design to extension the spark plug thread in the deep hole for easier testing.
- Thread: 14mm.



**OT-163B
EXTRA LONG INTERNAL SPARK PLUG
RETHREAD TOOL (M12x1.25)**

- Special designed for chasing spark plug threads from inside the cylinder head and working outward.
- Use the good threads at the base of port.
- Reduced dirt and metal debris from being driven into the cylinder head.



**OT-163C
EXTRA LONG INTERNAL SPARK PLUG
RETHREAD TOOL (M14x1.25)**

- Special designed for chasing spark plug threads from inside the cylinder head and working outward.
- Use the good threads at the base of port.
- Reduced dirt and metal debris from being driven into the cylinder head.



**OT-164
AIR OPERATED VALVE LAPPER**

- Design for operating in tough environments.
- Adjustable speed regulator for precise control during operation.
- Complete with rubber caps of 20mm, 30mm, 35mm and 45mm

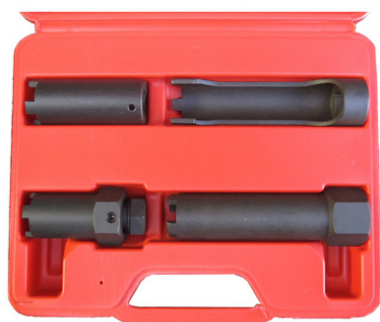

**OT-165
4 PCS TOOTHED SOCKETS FOR TRUCK DIESEL
PRESSURE AND INJECTOR**

Square drive nominal size 12.5 = 1/2",

for mounting, dismounting and tightening the pressure nut at the nozzle holder on commercial vehicles Mercedes-Benz M 401/421, M 402/422, LA, A, M 403/423, M 470h,

- 1/2"Dr. x 72mm(L) x 4 toothes
Mercedes Trucks engines OM401/421,OM403/423,LA,A,OM470
 - H32 x 70mm(L) x 4 toothes With M14 x 1.5mm receiver thread
Mercedes Trucks,Neoplan,Setra
 - H32 x 120mm(L) x 4 toothes -- MAN.Mercedes
 - 1/2"Dr. x 120mm(L) x 3 toothes -- Mercedes Trucks
- Also for IVECO,SCANIA,RENAULT.



**OT-167
SOCKET CAN USE FOR SIEMENS & BOSCH**

- 1/2" DR. socket can use for SIEMENS & BOSCH
- Size: 25, 27, 29 , 30mm

Suitable for Peugeot and Citroen with 2.0 engines (110/135HP) HDI engine.



**OT-170
CLUTCH HUB AND ALTERNATOR PULLER
(FOR MOTORCYCLES)**

Ideal tools to remove the indicated clutch plates.

OT-174

6-PIECES SLOTTED SPECIALI SOCKET SET



- Slotted sockets in 3/8"DR(10, 11, 12, 14mm) and 1/2"DR(17, 19mm) x 6PT x 77mmL
- For the assembly of top and side wired temperature sensors, thermo switches and other components
- Also suitable for nuts and bolts of bent pipes
- the slot width is: 7.4 mm, 8.8 mm, 9.1mm, 10.5 mm, 13.3 mm und 14.4 mm
- On socket rail

OT-203B

DIESEL INJECTOR PULLER



- Assists removal of stubborn bosch and lucas diesel injectors-saves time and money when injectors are difficult to remove.
- With M8/M12/M14 Adaptors

OT-209

7PCS OXYGEN SENSOR WRENCH SET



ST-305 : 1/2"DR. x 29mm x 6PT x 90mm long.

ST-306 : 3/8"DR. x 7/8" x 6PT x 90mm long.

ST-307 : 3/8"DR. x 7/8" x 6PT x 80mm long.

ST-308 : 1/2"DR. x 7/8" x 50mm long.

ST-309 : 3/8"DR. x 7/8" x 30mm long.

ST-312 : 1/2"DR. x 27mm x 12PT x 78mm long.

ST-315 : 3/8"DR. x 1" & 1-1/16" x 74mm long.

For use on Lambda sensors (oxygen sensors) on most modern cars.

This tool covers a wide variety of options and fits most heated and non-heated sensors.

OT-209A

4PCS DIESEL INJECTION SOCKET SET



ST-312 : 1/2"DR. x 27mm x 12PT x 78mm long.

ST-313 : 1/2"DR. x 22mm x 12PT x 78mm long.

ST-314 : 1/2"DR. x 22mm x 6PT x 110mm long.

ST-329 : 1/2"DR. x 28mm x 12PT x 78mm long.

A set of window sockets for allowing the diesel injectors to be removed. Suitable for use on Alfa Romeo, Audi, BMW, Chrysler, Ford, Mercedes, Peugeot, Rover, Seat Vauxhall and Volvo



OT-209B

10PCS OXYGEN SENSOR WRENCH AND DIESEL INJECTION SOCKET SET

ST-305 : 1/2"DR. x 29mm x 6PT x 90mm long.

ST-306 : 3/8"DR. x 7/8" x 6PT x 90mm long.

ST-307 : 3/8"DR. x 7/8" x 6PT x 80mm long.

ST-308 : 1/2"DR. x 7/8" x 50mm long.

ST-309 : 3/8"DR. x 7/8" x 30mm long.

ST-312 : 1/2"DR. x 27mm x 12PT x 78mm long.

ST-313 : 1/2"DR. x 22mm x 12PT x 78mm long.

ST-314 : 1/2"DR. x 22mm x 6PT x 110mm long.

ST-315 : 3/8"DR. x 1" & 1-1/16" x 74mm long.

ST-329 : 1/2"DR. x 28mm x 12PT x 78mm long.



OT-209C

6PCS DIESEL INJECTION SOCKET SET

ST-312 : 1/2"DR. x 27mm x 12PT x 78mm long.

ST-313 : 1/2"DR. x 22mm x 12PT x 78mm long.

ST-314 : 1/2"DR. x 22mm x 6PT x 110mm long.

ST-329 : 1/2"DR. x 28mm x 12PT x 78mm long.

ST-347 : 1/2"DR x 21mm x 12PT x 90mm long.

ST-348 : 1/2"DR x 28mm x 6PT x 83mm long.

Diesel Injector Socket Set for Alfa Romeo, Audi, BMW, Chrysler, Ford, Mercedes, Peugeot, Rover, Seat, Vauxhall and Volvo. Also Ford duratorq engines fitted to ford mondeo and transit also included a new injector socket for chrysler voyager and V/M engines fitted to land rovers. Manufactured from chrome molybdenum in black finish and Packed in a Blow case.



OT-209F

2PC OXYGEN SENSOR SOCKET & WRENCH

ST-308: HEATED OXYGEN SENSOR SOCKET

1/2" DR. x 7/8"(22mm) x 50mm long.

ST-309: OFFSET OXYGEN SENSOR WRENCH

3/8" DR. x 7/8"(22mm) x 50mm long.



OT-209G

3PC OXYGEN SENSOR SOCKET & VACUUM SWITCH SOCKET

ST-308: HEATED OXYGEN SENSOR SOCKET

1/2" DR. x 7/8"(22mm) x 50mm long.

ST-309A:VACUUM SWITCH SOCKET

3/8" DR. x 7/8" (22mm)x 30mm long.

ST-307.C: VACUUM SWITCH SOCKET

3/8"DR. 7/8"(22mm) x 6PT x 80mm long.



OT-209H

5PC OXYGEN SENSOR SOCKET & VACUUM SWITCH SOCKET & SPARK PLUG HOLE THREAD CHASER SET

ST-308: HEATED OXYGEN SENSOR SOCKET

1/2" DR. x 7/8"(22mm) x 50mm long.

ST-309A:VACUUM SWITCH SOCKET

3/8" DR. x 7/8" (22mm)x 30mm long.

ST-307.C: VACUUM SWITCH SOCKET

3/8"DR. 7/8"(22mm) x 6PT x 80mm long.

Tapered 12m/m and 18m/m threads designed to start and remove carbon & dirt or straighten damaged threads in spark plug hole. Use with deep socket, open ends or boxes wrench.



OT-209-11

11PC SPECILITY SOCKET SET

- (ST-305)1/2"x29x90mmL (6PT)
- (ST-306)3/8"x22x90mmL (6PT)
- (ST-307)3/8"22x80mmL (6PT)
- (ST-308)1/2"x22x6PT OFFSET OXYGEN SENSOR SOCKET.
- (ST-309) 3/8"x22x6PT OFFSET DEEP OXYGEN SENSOR SOCKET.
- (ST-309A) 3/8"x22x6PT OFFSET DEEP OXYGEN SENSOR SOCKET.
- (ST-312)1/2"x27x12PTx78L:SEAT, AUDI, VW, SKODA, BMW, MERCEDES, OPEL FORD, NISSAN, MITSUBISHI, LIN COLN(USA).
- (ST-315) 3/8"x 1" & 1-1/16" x 74mmL
- (ST-351)1/2" square drive, 1" male hex drive on top , 7/8" 6-point
- (OT-145C) SPARK PLUG HOLE THREAD CHASER M18 x 1.5 , Subtense : 22mm opening, 3-7/8" long.
- (ST-363) 1/2" 22x6PTx88mmL

OT-209-14

14PC SPECILITY SOCKET SET



- (ST-357)1/2"x17x12PTx78L:REUAULT.
- (ST-355)1/2"x19x12PTx78L:VW POLO, AUDI, SEAT, MAZDA.
- (ST-356)1/2"x20x6PTx78L:ABIERTU JAPAN.
- (ST-354)1/2"x27x6PTx78L:ABIERTU JAPAN.
- (ST-347)1/2"x21x12PTx90L:SEAT, AUDI,VW,SKODA,ALFA, ROMEO, MITSUBISHI.
- (ST-313A)1/2"x22x12PTx78L:SEAT, AUDI,VW, SKODA,OPEL.
- (ST-352)1/2"x22x12PTx110L:MERCEDES, CITROEN, PEUGEOT, FORD, NISSAN. MAZDA, MITSUBISHI, SEAT, AUDI,VW, ETC.
- (ST-312)1/2"x27x12PTx78L:SEAT, AUDI, VW, SKODA, BMW, MERCEDES, OPEL FORD, NISSAN, MITSUBISHI, LIN COLN(USA).
- (ST-358)1/2"x27x12PTx110L:CITROEN,PEUGEOT,SISTEN LVCAS.
- (ST-329)1/2"x28x12PTx78L:ALFA ROMEO, FIAT, ROVER, OPEL.
- (ST-311-30A)1/2"x30x12PTx78L:MERCEDES.
- (ST-353) 1/2"x22x12PTx150L.
- (ST-308)1/2"x22x6PT OFFSET OXYGEN SENSOR SOCKET.
- (ST-309) 3/8"x22x6PT OFFSET DEEP OXYGEN SENSOR SOCKET.

OT-209-21

21PC SPECILITY SOCKET SET



- (ST-357)1/2"x17x12PTx78L:REUAULT.
- (ST-355)1/2"x19x12PTx78L:VW POLO, AUDI, SEAT, MAZDA.
- (ST-356)1/2"x20x6PTx78L:ABIERTU JAPAN.
- (ST-354)1/2"x27x6PTx78L:ABIERTU JAPAN.
- (ST-347)1/2"x21x12PTx90L:SEAT, AUDI,VW,SKODA,ALFA, ROMEO, MITSUBISHI.
- (ST-313A)1/2"x 22x12PTx78L:SEAT, AUDI,VW, SKODA,OPEL.
- (ST-352)1/2"x22x12PTx110L:MERCEDES, CITROEN, PEUGEOT, FORD, NISSAN. MAZDA, MITSUBISHI, SEAT, AUDI,VW, ETC.
- (ST-312)1/2"x27x12PTx78L:SEAT, AUDI, VW, SKODA, BMW, MERCEDES, OPEL FORD, NISSAN, MITSUBISHI, LIN COLN(USA).
- (ST-358)1/2"x27x12PTx110L:CITROEN,PEUGEOT,SISTEN LVCAS.
- (ST-329)1/2"x28x12PTx78L:ALFA ROMEO, FIAT, ROVER, OPEL.
- (ST-311-30A)1/2"x30x12PTx78L:MERCEDES.
- (ST-308)1/2"x22x6PT OFFSET OXYGEN SENSOR SOCKET.
- (ST-309) 3/8"x22x6PT OFFSET DEEP OXYGEN SENSOR SOCKET.
- (ST-305)1/2"x29x90mmL (6PT) • (ST-306)3/8"x22x90mmL (6PT)
- (ST-307)3/8"22x80mmL (6PT)
- (ST-315) 3/8"x 1" & 1-1/16" x 74mmL
- (ST-348) 1/2"X28x83mmL (6PT) • (ST-353) 1/2"x22x12PTx150L.
- (LY-028) 22mm (6PT) FLEXIBLE OXYGEN SENSOR SOCKET WRENCH
- (ST-359)HEX:1/2"x 22mm : ANGLED SOCKET: VW,AUDI,BMW, MERCEDES,FORD,OPEL/VAUXHALL,REUAULT,CITROEN, RENAULT,SEAT,SKODA,JAPANESE CARS.



LY-028

3/8"DR.FLEXIBLE OXYGEN SENSOR SOCKET WRENCH

- Removes & Installs sensors on Computerized. Engine Control Vehicles.
- 3/8"Dr. x 22mm 6PT Socket with Cutaway Portion For Wire Clearance.
- Flexible design for Contined areas.
- Alloy Steel Construction.

OT-217

5PCS DIESEL INJECTOR SEAT CUTTER SET

- Re-face the diesel injector seat in order for the new or reconditioned injector to be fitted correctly.
- Clean and re-cutting of injector seat.
- Avoid a high risk of "blow-by" occurring cause of the build up of carbon deposits and the effects of corrosion.
- Application for all modern common rail diesel engines.

Contents: * 15 x 19 mm flat reamer -- Universal applications

* 17 x 17 mm flat reamer -- Delphi / Bosch injectors (BMW / PSA/ RENAULT/ FORD)

* 17 x 19 mm flat reamer -- Bosch injectors (Mercedes CRD)

* 17 x 21 mm angled reamer-- Fiat / Iveco.

- Pilot post x 1pc

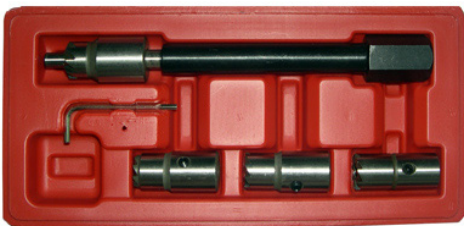

OT-217A

6PCS DIESEL INJECTOR SEAT CUTTER SET

* 15 x 19 mm flat reamer -- Universal applications

* 17 x 17 mm flat reamer -- Delphi / Bosch injectors (BMW / PSA/ RENAULT/ FORD)

* 17 x 19 mm flat reamer -- Bosch injectors (Mercedes CRD)

* 17 x 21 mm angled reamer-- Fiat / Iveco.

- T handle x 1pc
- Pilot post x 1pc



OT-217B

6PCS DIESEL INJECTOR SEAT CUTTER SET

* 15 x 19 mm flat reamer -- Universal applications

* 17 x 17 mm angled reamer -- Mercedes-Benz CDI

* 17 x 17 mm flat reamer -- Delphi / Bosch injectors (BMW / PSA/ RENAULT/ FORD)

* 17 x 19 mm flat reamer -- Bosch injectors (Mercedes CRD)

* 17 x 21 mm angled reamer-- Fiat / Iveco.

- Pilot post x 1pc





OT-217C

7PCS DIESEL INJECTOR SEAT CUTTER SET

- * 15 x 19 mm flat reamer -- Universal applications
- * 17 x 17 mm angled reamer -- Mercedes-Benz CDI
- * 17 x 17 mm flat reamer -- Delphi / Bosch injectors (BMW / PSA/ RENAULT/ FORD)
- * 17 x 19 mm flat reamer -- Bosch injectors (Mercedes CRD)
- * 17 x 21 mm angled reamer-- Fiat / Iveco.
- T handle x 1pc • Pilot post x 1pc



OT-217D

7PCS DIESEL INJECTOR SEAT CUTTER SET

- * 15 x 19 mm flat reamer -- Universal applications
- * 17 x 17 mm angled reamer -- Mercedes-Benz CDI
- * 17 x 17 mm flat reamer -- Delphi / Bosch injectors (BMW / PSA/ RENAULT/ FORD)
- * 17 x 19 mm flat reamer -- Bosch injectors (Mercedes CRD)
- * 17 x 21 mm angled reamer-- Fiat / Iveco.
- Injector Cleaner . • Pilot post x 1pc



OT-217E

8PCS DIESEL INJECTOR SEAT CUTTER SET

- * 15 x 19 mm flat reamer -- Universal applications
- * 17 x 17 mm angled reamer -- Mercedes-Benz CDI
- * 17 x 17 mm flat reamer -- Delphi / Bosch injectors (BMW / PSA/ RENAULT/ FORD)
- * 17 x 19 mm flat reamer -- Bosch injectors (Mercedes CRD)
- * 17 x 21 mm angled reamer-- Fiat / Iveco.
- T handle x 1pc • Injector Cleaner
- Pilot post x 1pc



OT-220

SERPENTINE BELT TOOL

For removing & Installing serpentine belts.

1/2", 3/8", square drive.

13, 15, 16, 18mm sockets.



**OT-220A
SERPENTINE BELT TOOL SET**

Releases tension on Serpentine Belts with spring loaded idler pulleys. Fits idler pulleys requiring 13, 15, 16, 18mm hex or 3/8" or 1/2" square drive. Also includes 13, 14 & 15mm crowfoot wrenches.



**OT-220C
SERPENTINE BELT TOOL SET**

Releases tension on Serpentine Belts with spring loaded idler pulleys. Fits idler pulleys requiring 15, 16, 18mm hex or 3/8" or 1/2" square drive. Also includes 13, 14 & 15mm crowfoot wrenches.



**OT-246
VALVE SEAL REMOVAL & INSTALLER KIT**

Works on both valves still seated or removed. Precision machined seal driving adapters guide the seal for proper setting.

- 1 pcs valve stem seal plier. (Long: 245mm)
- 1 pcs drive handle 6" (150mm) long.
- 2 pcs deep seal driving sockets for seals O.D. 10.8-14.8mm.
- 7 pcs seal driving adapters fit seals 5, 5.5, 6, 6.6, 7, 8, & 3/8".



**OT-246A
VALVE STEM SEAL PLIERS**

Long neck designed to reach into confined area of the seal to grip it for removal. Gripping serration in the allow them to grasp both original equipment & aftermarket seals regardless of the configuration.



**OT-246B
VALVE STEM SEAL PLIERS**

Designed to reach into confined area for removal of valve seal. Serrated tip for better grasp of valve seal regardless of its configuration.



OT-246C

VALVE SEAL REMOVAL & INSTALLER KIT

Works on both valves still seated or removed.

Precision machined seal driving adapters guide the seal for proper setting.

1 pcs valve stem seal plier. (Long: 270mm)

1pcs drive handle 6" (150mm) long.

2 pcs deep seal driving sockets for seals O.D. 10.8-14.8mm.

7 pcs seal driving adapters fit seals 5, 5.5, 6, 6.6, 7, 8, & 3/8".



OT-246D

VALVE STEM SEAL PLIERS

Long neck designed to reach into confined area of the seal to grip it for removal. Gripping serration in the allow them to grasp both original equipment & aftermarket seals regardless of the configuration.



OT-263

VALVE SPRING COMPRESSOR

Used for Car & Motorcycle.

Pusher size: 16mm, 19mm, 23mm, 25mm, and 30mm.

5pcs pusher for fitting the valve spring correctly and easier to compress the valve spring.



OT-296

UNIVERSAL VALVE REPAIR KIT

- Completes service tool kit for OHV & OHC petrol or diesel engines on Audi, Nissan, Toyota, Chrysler, Honda, Mazda, Mitsubishi, Porsche, Volvo, VW.



OT-296A

VALVE SPRING COMPRESSOR KIT

- Completes service tool kit for installation and removal of the valve spring without removal of cylinder head from the engine ,
- Applicable for OHV&OHC petrol/ diesel engine on Auid ,Nissan, Toyota, Chrysler, Honda, Mazda, Mitsubishi, Porsche, Volvo, VW.



OT-296B

UNIVERSAL VALVE REPAIR KIT

- Completed service tool kit for installation and removal of the valve spring without removal of cylinder head from the engine
- Application for OHV&OHC petrol/diesel engine on Audi, Nissan, Toyota, Chrysler, Honda, Mazda, Mitsubishi, Porsche, Volvo, VW



OT-296C

VALVE SPRING COMPRESSOR REPAIR KIT

- Completes service tool kit for OHV & OHC petrol or diesel engines.
- Use on AUDI, NISSAN, TOYOTA, CHRYSLER, HONDA, MAZDA, MITSUBISHI, PORSCHE, VOLVE, VW.



OT-296D

VALVE COLLET INSTALLING & PICK UP TOOL

- This tool holds the valve keepers in its magnetic jaws so you can easily maneuver the keepers into the valve stem grooves for installation.
- Easily reaches into recessed spring pocket to retrieve released valve keepers.
- Retrieves small parts from any recessed or hidden area.
- Contents: 3 pcs valve keeper installing tool Flexible magnetic pick up tool



OT-266

VALVE SPRING COMPRESSOR

Reversible jaw adaptor for multi-valve engines.

Capacity 45-145mm, throated clearance 250mm big window jaw adaptor for easy replacement of valve collects.

Dual size in 25mm and 30mm diameter.

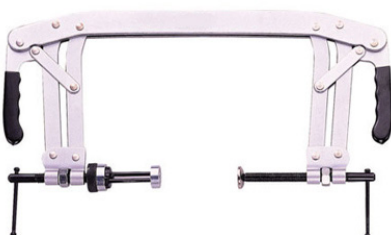

OT-266A

UNIVERSAL VALVE SPRING COMPRESSOR

- Suitable for use on multi-valve petrol & diesel engines with deep seated valves.
- Also for use with OHC OHV & CVH engines.
- Reversible jaw with 55mm-175mm capacity.
- 165mm throat depth.



OT-266B

OVERHEAD VALVE SPRING COMPRESSOR

- For use on a wide range of OHV, OHC and CHV engines.
- Not suitable for use on engines with deep seated valves.
- Allow valve springs and valve stem oil seals to be replaced with the cylinder head.
- Feature a reversible jaw/adaptor and automatic cam-action locking to a re-determined setting.



OT-259

METRIC SUMP PLUG KEY

Sump plug key

drain/plug key

For 8 different int. head size

■ : 10 · 11 · 12 · 13 · 14 · 15mm ◆ : 14 & 17mm



OT-259A-14

14PCS 3/8" DR.MASTER DRAIN PLUG KEY SET(36mmL)

- BMW, LANCIA, RENAULT, CITROEN, MAZDA, SAAB, FIAT, MERCEDES, TOYOTA, FORD, NISSAN, VAUXHALL/OPEL, HONDA, PEUGEOT, VOLKSWAGEN

6-3/8"Dr. Hex : 8-9-10-12-14-17mm

6-3/8"Dr. Square : 7-8-11-13mm & 5/16"-.3/8"

1-3/8"Dr. Female Square: 10mm

1-3/8"Dr. Triangular

CR-V steel , Mat Finished 20/15.5/16.5/0.82'



OT-259A-18

18PCS 3/8" DR.MASTER DRAIN PLUG KEY SET(36mmL)

- BMW, LANCIA, RENAULT, CITROEN, MAZDA, SAAB, FIAT, MERCEDES, TOYOTA, FORD, NISSAN, VAUXHALL/OPEL, HONDA, PEUGEOT, VOLKSWAGEN

6-3/8"Dr. Hex : 8-9-10-12-14-17mm

9-3/8"Dr. Square : 7-8-10-11-12-13-14mm & 5/16"-.3/8"

1-3/8"Dr. Female Square: 10mm

1-3/8"Dr. Triangular

CR-V steel ,Mat Finished 20/22.5/23.5/1'



OT-259A-18
18PCS 3/8" DR.MASTER DRAIN PLUG
KEY SET(36mmL)

• BMW, LANCIA, RENAULT, CITROEN, MAZDA, SAAB, FIAT,
 MERCEDES, TOYOTA, FORD, NISSAN, VAUXHALL/OPEL,
 HONDA, PEUGEOT, VOLKSWAGEN

3/8"Dr. x 36mm(L)

HEX : 8-9-10-12-14-17mm

SQUARE(■M) : 7-8-10-11-12-13-14mm & 5/16"-3/8"

SQUARE(□F) : 10mm

TRI(▲) : 10mm

SPLINE(12齒)中孔: M16 



OT-259A-21
21PCS 3/8" DR.MASTER DRAIN PLUG
KEY SET(36mmL)

• BMW, LANCIA, RENAULT, CITROEN, MAZDA, SAAB, FIAT,
 MERCEDES, TOYOTA, FORD, NISSAN, VAUXHALL/OPEL,
 HONDA, PEUGEOT, VOLKSWAGEN

Suitable for sump plugs on engine,gearbox and back axle

Contents:

Hex key socket: 8、9、10、12、13、14、17mm

Square socket : 5/16"、3/8"、7、8、10、11、12、13、14mm

Torx socket : T45

Triangular socket : 10mm

Spline (TAMPER) socket : M16

Square drive socket : 10mm

3/8"drive sliding T-handle

CR-V steel ,Mat Finished 12/ 18.3 /19.3/1.4'



OT-259-18
18PCS 3/8"DR.MASTER DRAIN PLUG
KEY SET(40mmL)

• BMW, LANCIA, RENAULT, CITROEN, MAZDA, SAAB, FIAT,
 MERCEDES, TOYOTA, FORD, NISSAN, VAUXHALL/OPEL,
 HONDA, PEUGEOT, VOLKSWAGEN

1-3/8"Dr. Sliding T-bar

6-3/8"Dr. Hex : 8-9-10-12-14-17mm

9-3/8"Dr. Square :7-8-10-11-12-13-14mm & 5/16"-3/8"

1-3/8"Dr. Female Square : 10mm

1-3/8"Dr. Triangular

CR-V steel ,Mat Finished 20/24/25/1'



**OT-261
CLUTCH ALIGNMENT SET**

- Align single disc clutches on most vehicles, light truck & tractors.
- Properly aligns clutch plate by tapered cone fitting into pilot bushing or bearing.
- Size: 8 collects ranging from 0.465" (11.8mm) to 0.980" (24.9mm).



**OT-261A
UNIVERSAL CLUTCH PILOT TOOL SET
(SAE & METRIC)**

- Accurately machined steel allows for fast and precise alignment of clutch plate to flywheel fits most single disc clutches on most of the cars & trucks.
- Includes 6 standard two-step sea adapters and 2 black oxide two step metric adapters.



**OT-261C
17PCS UNIVERSAL CLUTCH ALIGNING TOOL SET**

Chemically blackened steel components in presentation box.
Aids alignment of clutch plate for assembly.

Applications:

Audi, Citroen, Fiat, Ford, Honda, Mazda, Mitsubishi, Nissan, Opel, Peugeot, Renault, Rover, Saab, Toyota, Vauxhall, VW, Volvo.

SIZE OF CENTER BUSH

SIZE OF END BUSH

.....				
A	B	C	A	B	C
1)	15.5 x	14.2 x 26.6mm	1)	12.6 x	10.8 x 19.2mm
2)	16.7 x	15.4 x 27.0mm	2)	14.8 x	12.2 x 19.4mm
3)	19.0 x	17.5 x 28.0mm	3)	15.0 x	13.5 x 19.3mm
4)	20.0 x	18.6 x 27.5mm	4)	16.0 x	14.7 x 19.7mm
5)	21.4 x	20.0 x 27.4mm	5)	17.7 x	15.8 x 19.4mm
6)	23.0 x	21.6 x 27.5mm	6)	19.0 x	17.1 x 19.3mm
7)	23.5 x	22.0 x 27.5mm	7)	20.0 x	18.3 x 19.1mm
8)	26.6 x	24.2 x 27.5mm	8)	21.6 x	20.0 x 19.1mm



OT-268

3/8" OIL FILTER SOCKET (3PCS)

Chemically blackened, chrome vanadium steel socket. Low profile design enables use on cartridge style filters

- ST-345-27: 3/8" x 27mm x 6PT x 30mm long.
Applications: Mercedes A Class.
- ST-345-32: 3/8" x 32mm x 6PT x 30mm long.
Applications: GM/Opel,Astra G, Corsa B, Zafira.
- ST-345-36: 3/8" x 36mm x 6PT x 30mm long.
Applications: BMW, Ford, Mondeo 2.0D Duratorq,
Transit 2.0 & GM/Opel, Omega,
Vectra B,Zafira(98on), Mercedes.



OT-268A

3/8" OIL FILTER SOCKET (4 PCS)

Chemically blackened, chrome vanadium steel socket. Low profile design enables use on cartridge style filters

- ST-345-27: 3/8" x 27mm x 6PT x 30mm long.
Applications: Mercedes A Class.
- ST-345-32: 3/8" x 32mm x 6PT x 30mm long.
Applications: GM/Opel,Astra G, Corsa B, Zafira.
- ST-345-36: 3/8" x 36mm x 6PT x 30mm long.
Applications: BMW, Ford, Mondeo 2.0D Duratorq,
Transit 2.0 & GM/Opel, Omega,
Vectra B,Zafira(98on), Mercedes.
- ST-345-38: 3/8" x 38mm x 6PT x 30mm long.
Applications: Vauxhall Vectra 2.0D



OT-268B

3/8" OIL FILTER SOCKET (5 PCS)

Chemically blackened, chrome vanadium steel socket. Low profile design enables use on cartridge style filters

- ST-345-24: 3/8" x 24mm x 6PT x 30mm long. Applications: BMW.
- ST-345-27: 3/8" x 27mm x 6PT x 30mm long.
Applications: Mercedes A Class.
- ST-345-32: 3/8" x 32mm x 6PT x 30mm long.
Applications: GM/Opel,Astra G, Corsa B, Zafira.
- ST-345-36: 3/8" x 36mm x 6PT x 30mm long.
Applications: BMW, Ford, Mondeo 2.0D Duratorq,
Transit 2.0 & GM/Opel, Omega,
Vectra B,Zafira(98on), Mercedes.
- ST-345-38: 3/8" x 38mm x 6PT x 30mm long.
Applications: Vauxhall Vectra 2.0D



OT-268E

3/8" OIL FILTER SOCKET (7 PCS)

Chemically blackened, chrome vanadium steel socket. Low profile design enables use on cartridge style filters

- ST-345-24: 3/8" x 24mm x 6PT x 30mm long. Applications: BMW.
- ST-345-27: 3/8" x 27mm x 6PT x 30mm long.
Applications: Mercedes A Class.
- ST-345-32: 3/8" x 32mm x 6PT x 30mm long.
Applications: GM/Opel, Astra G, Corsa B, Zafira.
- ST-345-36: 3/8" x 36mm x 6PT x 30mm long.
Applications: BMW, Ford, Mondeo 2.0D Duratorq,
Transit 2.0 & GM/Opel, Omega,
Vectra B, Zafira(98on), Mercedes.
- ST-345-38: 3/8" x 38mm x 6PT x 30mm long.
Applications: Vauxhall Vectra 2.0D
- ST-345-29 : 3/8" x 29mm x 6PT x 30mm long.
- ST-345-30 : 3/8" x 30mm x 6PT x 30mm long.



OT-270

FLOW METER COMMON RAIL ADAPTOR SET

The purpose of this instrument is to measure rapidly and effectively the amount of fuel that every injector returns to the deposit tank, so that you will know if any injector is damaged.

Features:

- Direct measurement of return flow of the injector
- Measurement of return flow using external flow meter
- Possibility of simultaneous measurement of up to 6 injectors
- Box for transportation and storage is included
- Set included 24pc injector adaptors for BOSCH, SIEMENS, DENSO and DELPHI injector

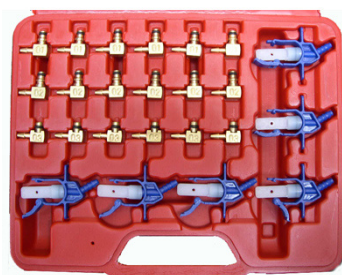

OT-270A

24PCS SET FOR FLOW METER COMMON RAIL

- Direct measurement of return flow of the injector
- Measurement of return flow using external flow meter
- Possibility of simultaneous measurement of up to 6 injectors
- Box for transportation and storage is included
- Set included 24pc injector adaptors : apply for BOSH-01, SIEMENS, DENSO-03 and DELPHI injector.



OT-270B FLOW METER COMMON RAIL SET

The purpose of this instrument is to measure rapidly and effectively the amount of fuel that every injector returns to the deposit tank, so that you will know if any injector is damaged.

Features:

- Direct measurement of return flow of the injector
- Measurement of return flow using external flow meter
- Possibility of simultaneous measurement of up to 6 injectors
- Box for transportation and storage is included



OT-270C FLOW METER COMMON RAIL ADAPTOR SET

The purpose of this instrument is to measure rapidly and effectively the amount of fuel that every injector returns to the deposit tank, so that you will know if any injector is damaged.

Features:

- Direct measurement of return flow of the injector
- Measurement of return flow using external flow meter
- Possibility of simultaneous measurement of up to 6 injectors
- Box for transportation and storage is included
- Set included 32pc injector adaptors for BOSCH, SIEMENS, DENSO and DELPHI injector



OT-287 PULLER FOR RIBBED DRIVE PULLEYS

- Clamps onto any ribbed pulley.
- Suitable for use on crankshafts, alternators, air conditioning units and water pumps.

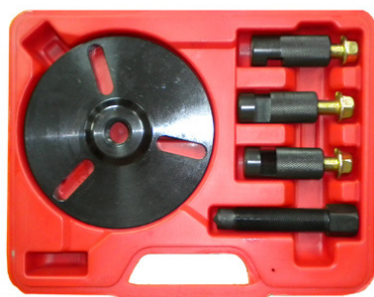

OT-288 UNIVERSAL CAMSHAFT SPROCKET PULLER

- Hold the sprocket and undo the retaining bolt or nut and remove.
- This tool enables the removal of the camshaft sprocket on a wide range of vehicles.
- Suitable: 45 ~ 70mm



**OT-288A
TIMING PULLEY PULLER**

- Draws pulleys by the holes without causing damage.
- Moving legs adapt to differing pulley diameters.
- Compact design for use with engine in situ.



**OT-292
CAMSHAFT PULLEY REMOVER / INSTALLER**

- Designed to hold the camshaft pulley stationary while loosening and tightening the center shaft bolt.
- Using the centered screw rod to uproot the pulley.
- Locking screw: M8, M10
- Fixed distance: 54~120mm



**OT-292A
CHANGEABLE TWO JAWS PULLEY REMOVER**

- Suitable for using when the space limited.
- To change the parts easily for fitting the different cars.
- Jaw length: 72/95mm.
- Jaw depth: 18mm; width: 4.4mm.



**OT-294
TOYOTA CAM TOOL / WRENCH SPANNER**

- Universal design fits many different types of pulleys having slots or holes, including camshaft pulleys and crankshaft pulleys.
- Wrench is adjustable from 1-1/4" to 5", works with 1/2" ratchet or breaker bar.



**AT-504
"O" RING AND SEAL PICK**

1pc combination pick.



AT-504A
5 PCS HOOK & PICK SET

- Stainless steel points.
- Set contains awl, hook tool, 45° & 90° bent tool.
- Use for detail works and scribing, picking jobs.

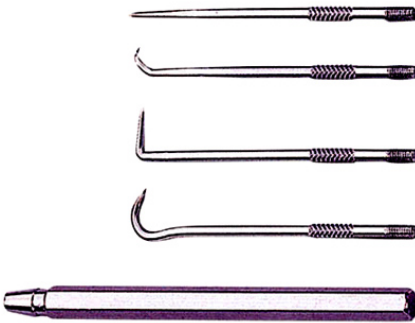

AT-504B
5 PCS HOOK & PICK SET

- Stainless steel points.
- Set contains awl, hook tool, 45° & 90° bent tool.
- Use for detail works and scribing, picking jobs.

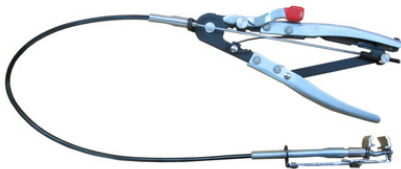

AT-225
UNIVERSAL HOSE CLAMP REMOVER

- For replacement of fuel, oil and water hose.
- Hose clamp with flexible 600mm wire.
- Convenient for working hidden areas and long distance.



AT-533
ADJUSTABLE FUEL TANK LID REMOVER

To adjust from the middle track.

You can use on all kinds of vehicle with salient fuel tank lid.

Applicable: Benz, BMW, European cars, etc.



CZS-006
3/8"DR. X 14mm FLARE NUT WRENCH

- Used for TOYOTA · HONDA bolts of fuel filter cup.
- Full length 94mm · suit for narrow place.
- Special design with cover for holding the nut completely and prevent slipping.



CZS-006A

3/8"DR. X 17mm FLARE NUT WRENCH

- Used for TOYOTA , HONDA bolts of fuel filter cup.
- Full length 97mm , suit for limited space.
- Special design with cover for holding the nut completely and prevent slipping.



CZS-014

THIN TYPE TWO JAWS BRARING REMOVER

- Special design for removing the bearing in narrow space.
- Working depth: 93mm
- Jaws thickness : 1.5mm
- Applicable bearing dimension : ϕ 30~90mm



AK013

13PCS COMBINED SOCKET SET FOR ALTERNATOR

- 2- Combined Socket for Alternator :
 - T50 x 110mm(L) & M10 x 110mm(L)
 - 2-15mm Hex x 33 Teeth
 - 22mm Hex x 33 Teeth
 - 1- Special tool for Bosch System Alternator :
 - ϕ 34.5 x H15 mm x 30L
 - 1- Special tool for Renault System Alternators :
 - H28 x H 22 mm x 30L
 - 1-1/2"Dr. Bit Adaptor
 - 6-10mm x 75L BIT:
 - Torx: T40-T50 & Spline : M8-M10 & Hex: H8-H10
 - Special design to stop the pulley and remove the centre bolts to remove the v-belt pulley at the generator.
 - Applicable : VW GOLF, VENTO , PASSAT ,AUDI A3, and VOLVo.
 - Combined Socket for Alternator : 1/2"*100L
 - T50 : BENZ A series
 - M10 : BENZ , BMW , AUDI, FORD, SKIDA , VW , etc.
 - 33 Teeth Socket : VW , AUDI.
- Packing : BMC 15sets / 16.5 / 17 / 0.9'



AK013A

13PCS COMBINED SOCKET SET FOR ALTERNATOR

2- Combined Socket for Alternator :

T50 x 110mm(L) & M10 x 110mm(L)

2-15mm Hex x 33 Teeth

22mm Hex x 33 Teeth

1- Special tool for Bosch System Alternator :

∅ 34.5 x H15 mm x 30L

1- Special tool for Renault System Alternators :

H22 x H 22 mm x 30L

1-1/2"Dr. Bit Adaptor

6-10mm x 75L BIT:

Torx: T40-T50 & Spline : M8-M10 & Hex: H8-H10

- Special design to stop the pulley and remove the centre bolts to remove the v-belt pulley at the generator.
- Applicable : VW GOLF, VENTO , PASSAT ,AUDI A3, and VOLVo.
- Combined Socket for Alternator : 1/2"x100L
T50 : BENZ A series
M10 : BENZ , BMW , AUDI, FORD, SKIDA , VW , etc.
- 33 Teeth Socket : VW , AUDI.

Packing : BMC 15sets / 16.5 / 17 / 0.9'



AK018

18PCS COMBINED SOCKET SET FOR ALTERNATOR

3- Combined Socket for Alternator :

1/2"Dr. x 110mm(L) : T50 & M10

3/8"Dr. x 89mm(L) : M10

2-15mm Hex x 33 Teeth

22mm Hex x 33 Teeth

1- Special tool for Bosch System Alternator :

∅ 34.5 x H15 mm x 30L

3- Special tool for Renault System Alternators :

H22 x H 22 mm x 30L

H28 x H 22 mm x 30L

H28 x H 19 mm x 30L

6-10mm x 75L BIT:

Torx: T40-T50 & Spline : M8-M10 & Hex: H8-H10

1-12mm x 64L BIT: Spline : M10

1-1/2"Dr. Spline Bit Socket (140mmL) : M10

1-1/2"Dr. Bit Adaptor

Packing : BMC 10sets / 17.8 / 18.8 / 1.3'



AK0013

13PCS COMBINED SOCKET SET FOR ALTERNATOR

2- Combined Socket for Alternator :

T50 x 110mm(L) & M10 x 110mm(L)

2-15mm Hex x 33 Teeth , 22mm Hex x 33 Teeth

1- Special tool for Bosch System Alternator :

§ 34.5 x H15 mm x 30L

1- Special tool for Renault System Alternators :

H22 x H 22 mm x 30L , 1-1/2"Dr. Bit Adaptor

6-10mm x 75L BIT:

Torx: T40-T50 & Spline : M8-M10 & Hex: H8-H10

- Special design to stop the pulley and remove the centre bolts to remove the v-belt pulley at the generator.
- Applicable : VW GOLF, VENTO , PASSAT ,AUDI A3, and VOLVo.
- Combined Socket for Alternator : 1/2"x100L
- T50 : BENZ A series
- M10 : BENZ , BMW , AUDI, FORD, SKIDA , VW , etc.
- 33 Teeth Socket : VW , AUDI.

Packing : BMC 15sets / 16.5 / 17 / 0.9'



AK0022

22PCS COMPLETE KIT FOR BOSCH AND DENSO TYPE ALTERNATOR PULLEYS

3-Combined Socket for Alternator. T50 x 113mmL Socket;

M10 x 113mmL Socket; 3/8" Dr.xM10x80mmL W / Ø 14x33T for Fiat.

1- Bit socket M10x140mmL.

3- Teeth Socket: 15mmx19mm HEX x 33 teeth; 22mm HEX x 33 teeth, 15mm x17.5mmHex x33 teeth.

2 – 22mm HEX Socket 17mm HEX Socket.

3- 22x28 mm Hex socket 19x28 mm Hex socket 21x28mm Hex socket.

1 – 35mm Round Socket W/4 pins. 1 - 38mmHex W/3Pins.

1 – 1/2" Dr. SQ.(F) x 10mm Hex.(F) Bits Adaptor.

1-M10xH12x64L bit.

6 – 10mm(Hex Shank) x 75mmL CR-V bit: T40, T50, M8, M10, H8, H10.

Features :

Removes and installs press-on-type belt drive accessory pulleys.

Works with hand tools or an impact gun.

Interchangeable components to work on VW, Audi, Seat, Mercedes Benz, Renault, BMW, Ford Renault, Fiat, etc....

- Combined Socket for Alternator : 1/2"x100L

T50 : BENZ A series

M10 : BENZ , BMW , AUDI, FORD, SKIDA , VW , etc.

- 33 Teeth Socket : VW , AUDI.

Packing : BMC 10sets / 21 / 22 / 1.6'



CYH-JGPS306-72
6PC 3/8"DR.JOINTED GLOW PLUG SOCKET SET

6-3/8"DR. X 82mm
 SIZE: 8-9-10-12-14-16mm
 Packing : BMC 24 sets/18 / 19 / 1.8'



CYH-JGPS306-72A (WITH CLIP)
6PC 3/8"DR.JOINTED GLOW PLUG SOCKET SET

6-3/8"DR. X 82mm
 SIZE: 8-9-10-12-14-16mm
 Packing : BMC 24 sets/18 / 19 / 1.8'



CYH-JGPS306-158
6PC 3/8"DR.JOINTED GLOW PLUG SOCKET SET

6-3/8"DR. X 158mm
 SIZE: 8mm (Mercedes , Vauxhall / Opel ,Fiat , Lancia)
 SIZE: 9mm (Vauxhall / Opel ,Fiat)
 SIZE: 10mm (Mercedes, VAG)
 SIZE: 12mm (Mercedes , VAG ,BMW ,Peugeot , Renault)
 SIZE: 14mm (Renault ,Citroen ,Peugeot)
 SIZE: 16mm (Alfa Romeo ,Fiat ,Ford ,Mazda,Citroen ,
 Peugeot ,Honda ,Mercedes ,Nissan ,Vauxhall ,Parsche)
 Packing : BMC 15 sets/ 21 / 22 / 1.9'



CYH-JGPS306-158A
6PC 3/8"DR.JOINTED GLOW PLUG SOCKET SET
(WITH CLIP)

6-3/8"DR. X 158mm
 SIZE: 8mm (Mercedes , Vauxhall / Opel ,Fiat , Lancia)
 SIZE: 9mm (Vauxhall / Opel ,Fiat)
 SIZE: 10mm (Mercedes, VAG)
 SIZE: 12mm (Mercedes , VAG ,BMW ,Peugeot , Renault)
 SIZE: 14mm (Renault ,Citroen ,Peugeot)
 SIZE: 16mm (Alfa Romeo ,Fiat ,Ford ,Mazda,Citroen ,
 Peugeot ,Honda ,Mercedes ,Nissan ,Vauxhall ,Parsche)
 Packing : BMC 15 sets/ 21 / 22 / 1.9'



CYH-DIJGPS3409

9PC DIESEL INJECTION SOCKET & JOINTED GLOW PLUG SOCKET SET

6-1/2"Dr. DIESEL INJECTION SOCKET:

27mm x 78mm (12PT) (ST-312) (CR-V)

22mm x 78mm (12PT) (ST-313) (CR-V)

28mm x 78mm (12PT) (ST-329) (CR-V)

22mm x 110mm (6PT) (ST-314) (CR-V)

21mm x 90mm (12PT) (ST-347) (CR-Mo)

28mm x 83mm (6PT) (ST-348) (CR-V)

3-3/8"DR. X 158mm JOINTED GLOW PLUG SOCKET:

SIZE: 8-10-12mm

(• Cr-V steel, Hardened & Matt Plated)

Packing : BMC 8 sets/20 / 21 / 1.7 '



ST-305

VACUUM SWITCH SOCKET

1/2"DR x 29mm x 6PT x 90mm long 7mm SLOT FOR



ST-306

3/8" Dr. OXYGEN SENSOR SOCKET

3/8"DR. 7/8"(22mm) x 6PT x 90mm long.

20mm slot for vacuum.

PVS TVS valve & oxygen sensor on Ford, GM, Chrysler & other cars.



ST-306A

1/2" Dr. OXYGEN SENSOR SOCKET

1/2" Dr. 7/8" (22m/m) x 90 mm long, 7mm slot for oxygen sensor on Japanese cars Ford, GM, Chrysler & other cars.



ST-306C

3/8" Dr. OXYGEN SENSOR SOCKET

3/8"DR. 7/8"(22mm) x 6PT x 90mm long.

20mm slot for vacuum.

PVS TVS valve & oxygen sensor on Ford, GM, Chrysler & other cars.



ST-306E

1/2" Dr. OXYGEN SENSOR SOCKET

1/2"DR. 7/8"(22mm) x 6PT x 90mm long.

20mm slot for vacuum.

PVS TVS valve & oxygen sensor on Ford, GM, Chrysler & other cars.



ST-306G

1/2"Dr. 22mm Oxygen sensor socket 87mmL

1/2DR" x 22mm x 6PT x 87mmL



ST-307

VACUUM SWITCH SOCKET

3/8"DR. 7/8"(22mm) x 6PT x 80mm long.

7mm slot for oxygen on computer engine controlled cars.



ST-308

HEATED OXYGEN SENSOR SOCKET

Needed for servicing today's computer-controlled vehicle systems.

Easily removes the oxygen sensor located in the exhaust manifold.

Heat treated cast steel.

Has 7/8" hex. 1/2" square drive (double square for easy access).

1/2" DR. x 7/8"(22mm) x 50mm long.



ST-309

OFFSET OXYGEN SENSOR WRENCH

This unique wrench has been developed for use on the LTI GENII 5.71 HO MPFI v-8 found in the 1993 and later Corvette, 1993 Camaro, and 1993 Firebird / TransAm.

Additional applications include the 1989 and later Corvette ZRI with the LTI 5.71 DOHC SFI v-8 as well as many other vehicles.

Made from quality alloy steel with a black finish and 3/8" square drive.

3/8" DR. x 7/8"(22mm) x 50mm long.



**ST-309A
VACUUM SWITCH SOCKET**

3/8" drive 7/8" flare nut socket or vacuum switch & oxgen sensor service on computer controlled engines.
3/8" DR. x 7/8" (22mm)x 30mm long.



**ST-309B
AUTO REPAIR TOOLS--22mm OXYGEN
SENSOR SOCKET**

3/8" drive 7/8" flare nut socket or vacuum switch & oxgen sensor service on computer controlled engines.
3/8" DR. x 7/8" (22mm)x 27mm long.



**ST-311-27A
INJECTOR SOCKET**

1/2" DR. x 27mm x 6PT x 78mm long.



**ST-312
INJECTOR SOCKET**

1/2" DR. x 27mm x 12PT x 78mm long.



**ST-313
INJECTOR SOCKET**

1/2" DR. x 22mm x 12PT x 78mm long.



**ST-313A
INJECTOR SOCKET**

1/2" DR. x 22mm x 12PT x 78mm long.



**ST-314
INJECTOR SOCKET**

1/2" DR. x 22mm x 6PT x 110mm long.



**ST-315
OIL SENDER UNIT SOCKET**

3/8" DR. x 1" & 1-1/16"(27mm) x 74mm long.

Alloy steel, heat treated black finished.

To remove and install 1-1/16" oil pressure sending units on GM and late Chrysler.

Use with 3/8" drive.



**ST-315A
OIL PRESSURE SWITCH SOCKET**

- For late model 2.0L , 2.3L , 2.5L , 2.8L , and 3.0L GMS with oil pressure sending units.

- Use with 1/2" drive wrench

- Alloy steel , heated treated , chrome plated.

- L : 90mm.

1/2" DR. x 1" & 1-1/16" x 90mm long.



**ST-329
INJECTOR SOCKET**

1/2" DR. x 28mm x 12PT x 78mm long.



ST-344
IMPACT SOCKET

1/2"DR x 22mm x 6PT x 80mm long.



ST-364
DIESEL INJECTOR SOCKET

1/2"DR. x 22mm x 6PT x 90mm long.



ST-346
INJECTOR SOCKET

1/2"DR. x 22mm x 6PT x 90mm long.



ST-347
INJECTOR SOCKET

1/2"DR. x 21mm x 12PT x 90mm long.



ST-348
INJECTOR SOCKET

1/2"DR x 28mm x 6PT x 83mm long.



ST-351

OXYGEN SENSOR SOCKET

- Works on all domestic and imported vehicles with oxygen sensors.
- Slot in socket's side allows wire clearance .
- Outside rib provides added strength, yet does not restrict access to sensors.
- 1/2" square drive, 1" male hex drive on top , 7/8" 6-point opening, 3-7/8" long.



ST-359

ANGLED SOCKET: 22mm Hex

With radially positioned 1/2" Drive as well as a radially displaced 1/2" Driver



ST-360

VACUUM SWITCH SOCKET

1/2"DR. 19mm x 6PT x 78mm long.

7mm slot for oxygen on computer engine controlled cars.



ST-363

22mm SPECIAL TUBE SOCKET

1/2"DR. x 22mm x 6PT x 88mmL



ST-365

OXYGEN SENSOR SOCKET 150mmL

1/2"DR. x 22mm x 6PT x 150mmL